

# MY MODERN SUPERHERO!

“Saving the Day” in 2013

*A Stylized Comic Project*



# What do you think of when you hear the word SUPERHERO?

*A very heroic person*



*A benevolent fictional character who has amazing powers (such as the ability to fly)*

*An exceptionally skillful or successful person*

# So, what will we be doing!?

## In this lesson, we will...

Create a comic strip about your own *modern day superhero*.

You will create a character who:

- Has super-human abilities
- Helps with a problem or issue that exists in the world today and “saves the day”

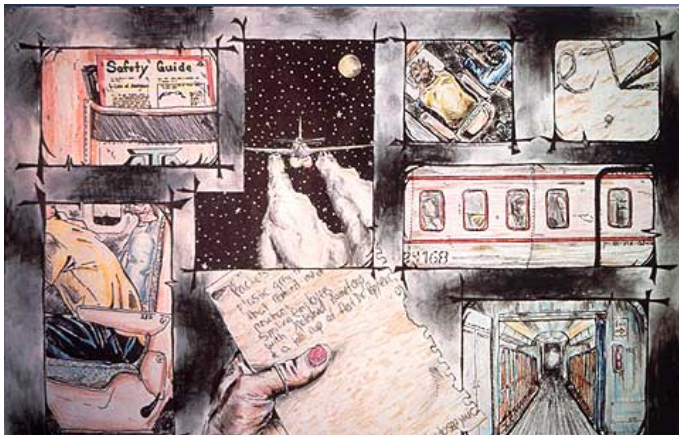

### ISSUE/CHACTER

STEP 1: Come up with your issue

STEP 2: Come up with your character

### STORY/STYLE

STEP 3: Choose your story

STEP 4: Choose your style

# DAY ONE:

## SUPERHERO CHARACTER BRAINSTORM

1. *Come up with the issue or dilemma that your hero will face*
2. *Come up with your character concept*



# SUPERHERO EXAMPLES:

Name: Ms. Kent  
Class: \_\_\_\_\_

WHAT IS YOUR SUPERHERO'S NAME?

**PARIA DUNKS**

WHAT ISSUE OR  
DILEMMA DO THEY  
FACE/WILL THEY FIX?

Sports  
injuries

WHAT POWERS DO THEY POSSESS?

Can instantly heal  
sprains, breaks, and  
bruises with her  
magical neon  
sweatbands

WHAT IS THEIR  
PERSONALITY LIKE?

Athletic, outgoing,  
energetic, helpful,  
goofy

CAN ANYTHING  
DEFEAT THEM?

Ice  
packs

DO THEY WEAR A UNIFORM?  
WHAT DOES IT LOOK  
LIKE/WHAT CAN IT DO?

Golden jersey +  
covered in  
neon sweatbands

DO THEY HAVE SIDE-KICKS?

Her  
sweatbands



Name: Ms. Kent  
Class: \_\_\_\_\_

WHAT IS YOUR SUPERHERO'S NAME?

Ice Block

WHAT ISSUE OR  
DILEMMA DO THEY  
FACE/WILL THEY FIX?

Kids getting  
teased /  
picked on

WHAT POWERS DO THEY POSSESS?

Freezes negative words with  
his eyes and turns them  
into blocks of ice  
(which he uses to build  
an ice castle in Antarctica)

WHAT IS THEIR  
PERSONALITY LIKE?

Intense, quick-thinking,  
fast-acting,  
highly intelligent

CAN ANYTHING  
DEFEAT THEM?

DO THEY WEAR A UNIFORM?  
WHAT DOES IT LOOK  
LIKE/WHAT CAN IT DO?

Full bodysuit, boots,  
gloves to protect  
from cold

DO THEY HAVE SIDE-KICKS?

Polar bear cubs



Name: Ms. Kent  
Class: \_\_\_\_\_

WHAT IS YOUR SUPERHERO'S NAME?

**SAYCHEESE** 

WHAT ISSUE OR  
DILEMMA DO THEY  
FACE/WILL THEY FIX?

People feeling  
gloomy during  
the winter

WHAT POWERS DO THEY POSSESS?

Can transport people to  
a beach day by  
taking a picture of  
them on their phone

WHAT IS THEIR  
PERSONALITY LIKE?

Easy-going, positive,  
always in a good  
mood

CAN ANYTHING  
DEFEAT THEM?

Blinking  
when flash  
goes off

DO THEY WEAR A UNIFORM?  
WHAT DOES IT LOOK  
LIKE/WHAT CAN IT DO?

Inter-tube and  
fins that allows  
him to "swim" through  
the air

DO THEY HAVE SIDE-KICKS?

magical phone



Name: Halsey  
Class: \_\_\_\_\_

**WHAT IS YOUR SUPERHERO'S NAME?**

Bak Atcha

**WHAT ISSUE OR DILEMMA DO THEY FACE/WILL THEY FIX?**

When people don't text back even though they read the text

**WHAT POWERS DO THEY POSSESS?**

He can turn cell phones into scrolls, which can only turn back into a phone when they write a letter to the person whose text they ignored

**WHAT IS THEIR PERSONALITY LIKE?**

thoughtful, quiet, kind, with a good memory... but with a sassy side

**CAN ANYTHING DEFEAT THEM?**

Snapchats

**DO THEY WEAR A UNIFORM? WHAT DOES IT LOOK LIKE/WHAT CAN IT DO?**

He is a cell phone!  
He uses his body to answer texts promptly!

**DO THEY HAVE SIDE-KICKS?**

Dr. Sass, who brings out Bak Atcha's sassy side

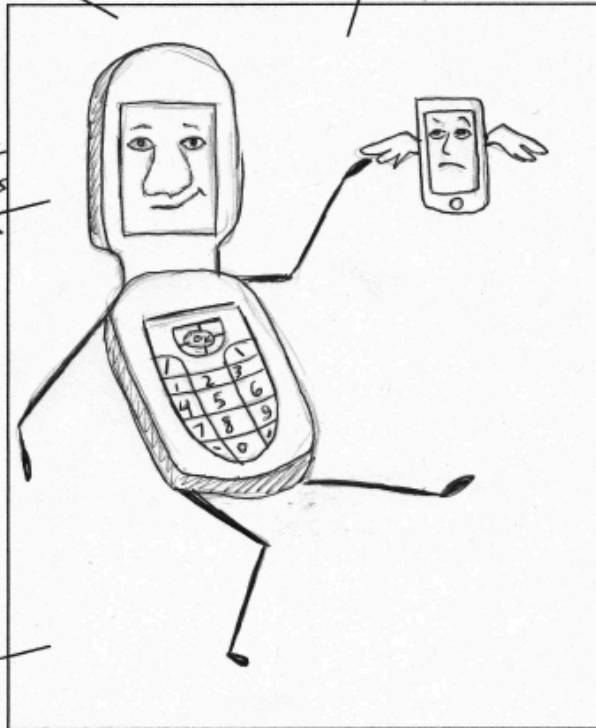



Name: Ms. Kent  
Class: \_\_\_\_\_

**WHAT IS YOUR SUPERHERO'S NAME?**  
**PIXEL**

**WHAT ISSUE OR DILEMMA DO THEY FACE/WILL THEY FIX?**  
cyber-bullying

**WHAT POWERS DO THEY POSSESS?**  
Swims in digital world,  
erases bullying comments,  
Turns screen of person  
blank- must apologize to  
release

**WHAT IS THEIR PERSONALITY LIKE?**  
tough, smart,  
fast, helpful

**CAN ANYTHING DEFEAT THEM?**  
no

**DO THEY WEAR A UNIFORM?  
WHAT DOES IT LOOK LIKE/  
WHAT CAN IT DO?**  
rainbow pixels  
emanating from  
feet

**DO THEY HAVE SIDE-KICKS?**  
giant  
eraser

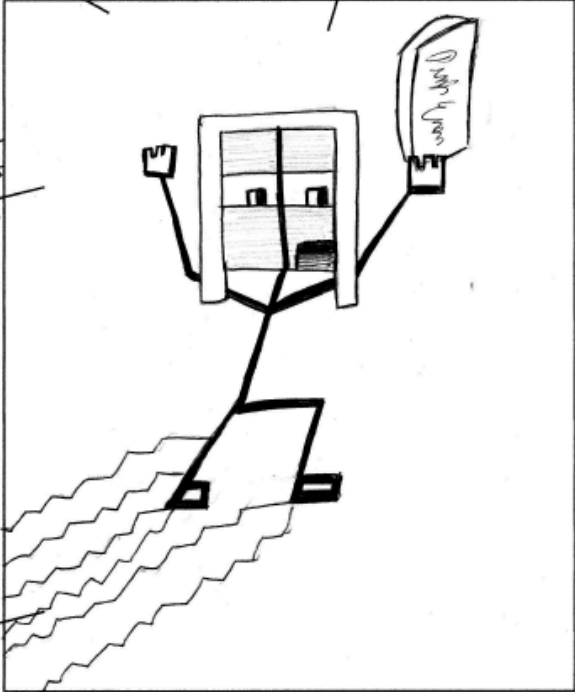

**NOW IT'S YOUR TURN!**

**Comic= Images and pictures placed in a sequence, intended to convey information and a response in the viewer.**



Humans have  
been  
communicating  
in this way  
for a LONG  
time



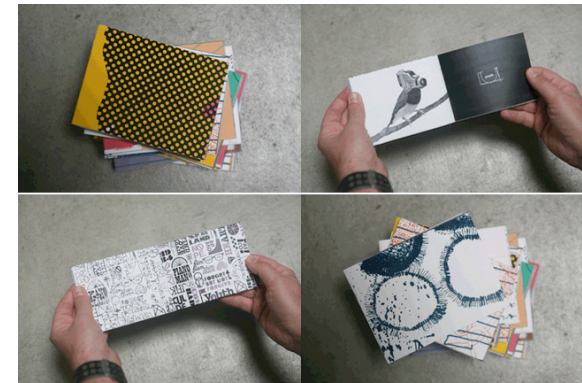

Today, artists take the form of the comic strip in many directions...



Some examples of where the comic style can be found...

# Comic Books



# Graphic Novels

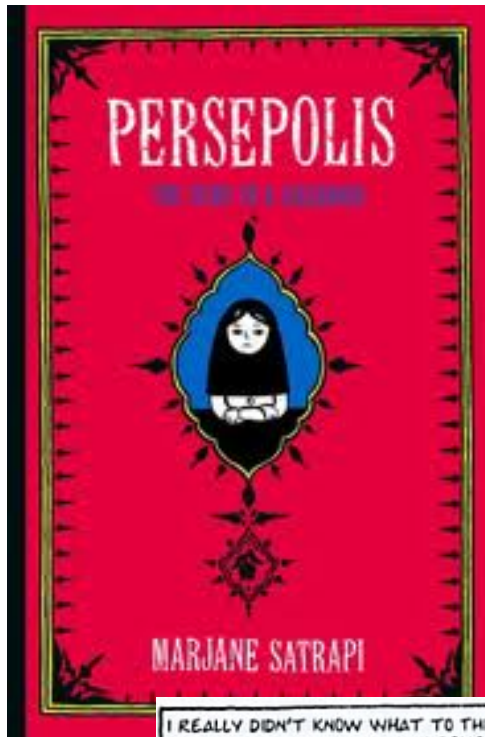

A novel that tells a story through images—either in traditional comic format or in an experimental style.

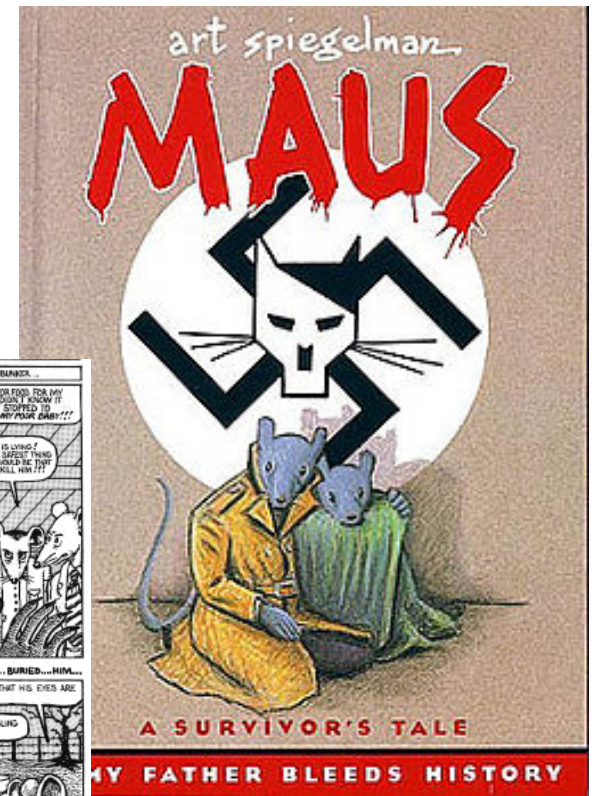



# Zines

Self-published magazines. Created with the idea that you do not need a publisher to get your ideas across! Zines are made in many different forms and often incorporate the traditional comic book style as well as other forms of text, drawing, painting, and collage.

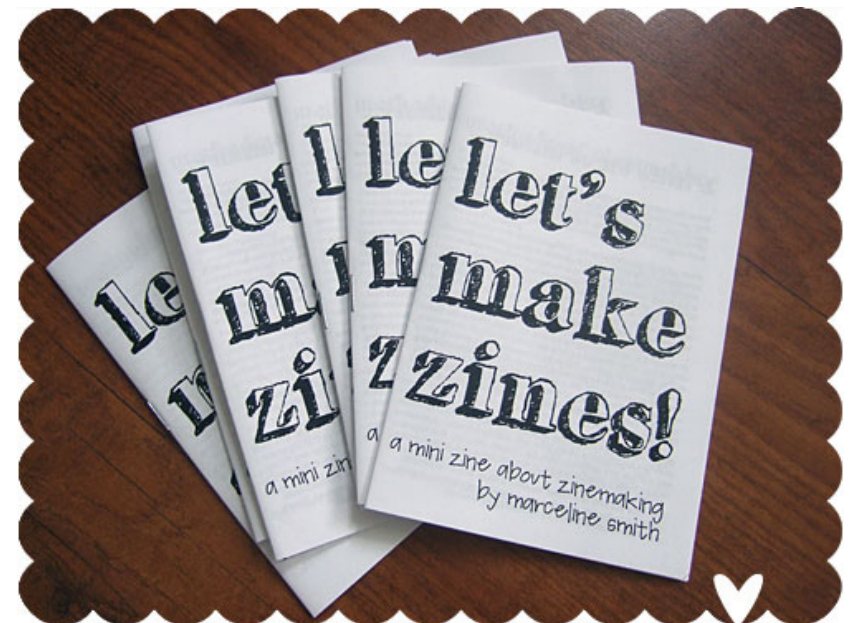
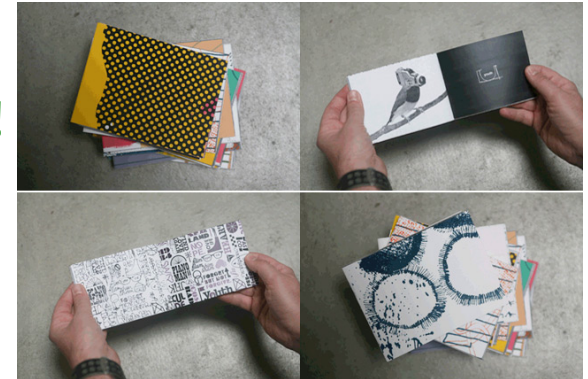





While you look through these examples,  
look out for these...

# COMIC ART ELEMENTS

# ICONS

The more abstract an image, the more universally meaningful it is. For example, ☺. The more realistic an image, the more particular it is to a certain story.

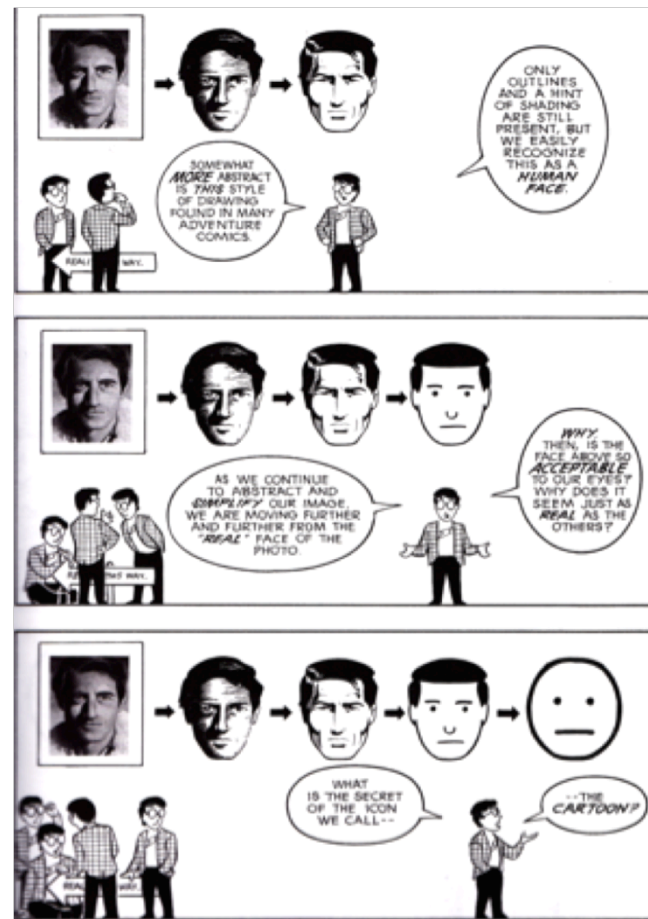

# LINE

How can we use line to convey different emotions?

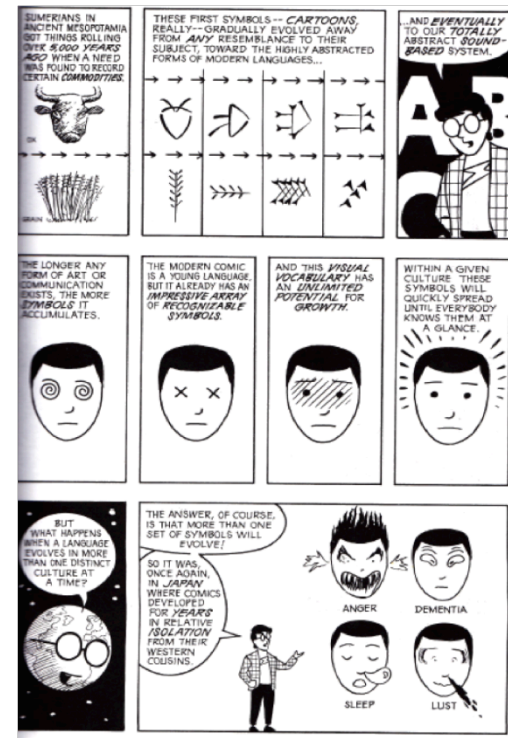
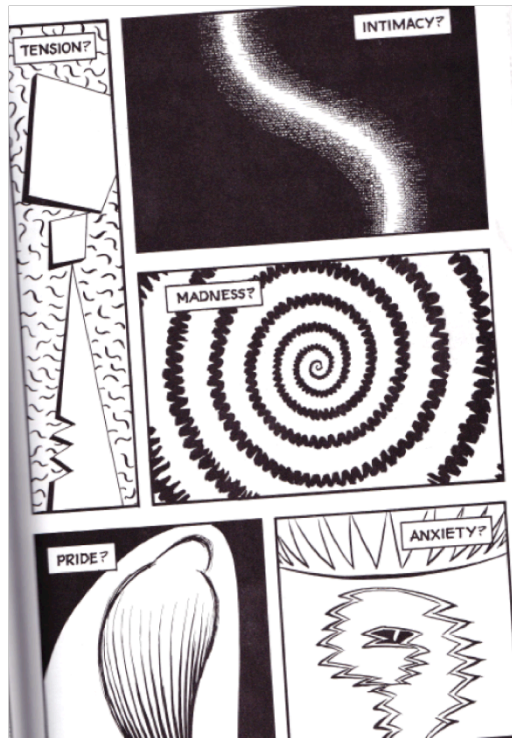
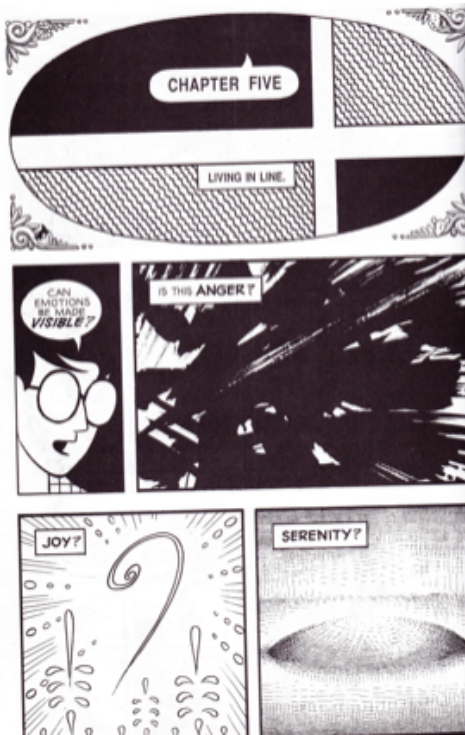

# TIME AND MOTION

Comic artists show time and motion through different techniques and transitions between scenes.

**1.** MOST *PANE-TO-PANE* TRANSITIONS IN COMICS CAN BE PLACED IN ONE OF SEVERAL DISTINCT CATEGORIES. THE *FIRST* CATEGORY -- WHICH WE'LL CALL *MOMENT-TO-MOMENT* -- REQUIRES VERY LITTLE CLOSURE.

**2.** *NEXT* ARE THOSE TRANSITIONS FEATURING A SINGLE *SUBJECT* IN DISTINCT *ACTION-TO-ACTION* PROGRESSIONS.

**3.** THE *NEXT* TYPE TAKES US FROM *SUBJECT-TO-SUBJECT* WHILE STAYING WITHIN A SCENE OR IDEA. NOTE THE DEGREE OF *READER INVOLVEMENT* NECESSARY TO RENDER THESE TRANSITIONS *MEANINGFUL*.

**4.** *DEDUCTIVE REASONING* IS OFTEN REQUIRED IN READING COMICS SUCH AS IN THESE *SCENE-TO-SCENE* TRANSITIONS, WHICH TRANSPORT US ACROSS *SIGNIFICANT DISTANCES* IN *TIME* AND *SPACE*.

**5.** A *FIFTH* TYPE OF TRANSITION, WHICH WE'LL CALL *ASPECT-TO-ASPECT*, BYPASSES *TIME* FOR THE MOST PART AND SETS A *WANDERING EYE* ON DIFFERENT *ASPECTS* OF A PLACE, IDEA OR MOOD.

**6.** AND FINALLY, THERE'S THE *NON-SEQUITUR*, WHICH OFFERS NO LOGICAL RELATIONSHIP BETWEEN PANELS *WHATSOEVER*.

# SEEN AND UNSEEN

Comics show what is happening in a moment, as well as things that we are not able to see in real life (like thought bubbles or flashbacks). They also rely on the reader to piece together the story without giving every detail.

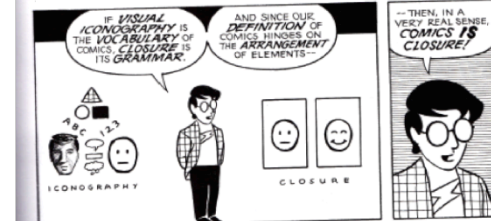
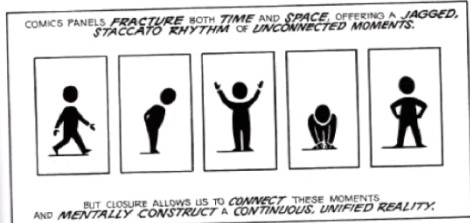
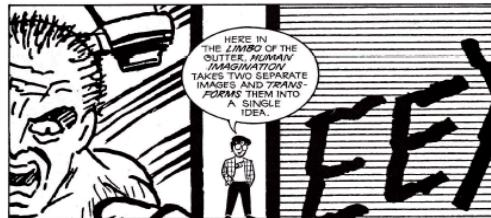
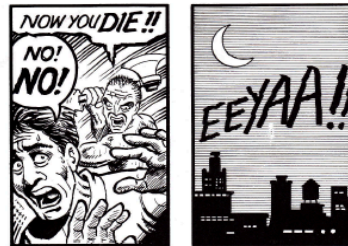
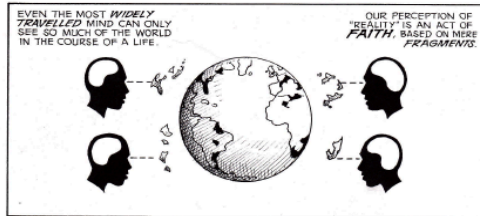
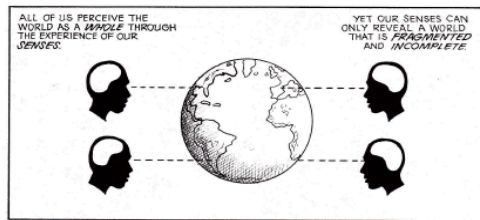



# STYLE

Individuals or groups of comic artists have different styles.



# TEXT

How do comic artists use text? How does it change the reading or meaning of the comic?

